



# TECAPRES®

Ø75mm  
4300daN

## TPH 4300.1

VDI SAFETY



PED  
2014/68/EU

EXTRA  
POWER

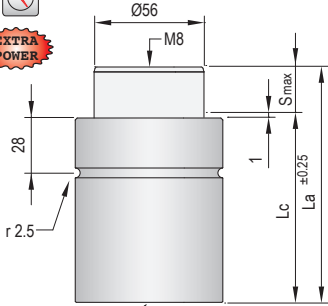

Gas charging M6  
TPFV3 valve  
M6-A adapter

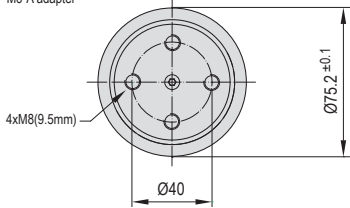

- Pressure medium **Nitrogen (N<sub>2</sub>)**
- Max. charging pressure **175 Bar**
- Min. charging pressure **35 Bar**
- Rod seal area **24,63 cm<sup>2</sup>**
- Operating temperature **0°C - 80°C**
- Force increase by temperature **0,33 %/°C**
- Max. stem speed **25 m/min**
- Maintenance kit **Kit H4300.1**



Maximum strokes / minute (at 20°C)

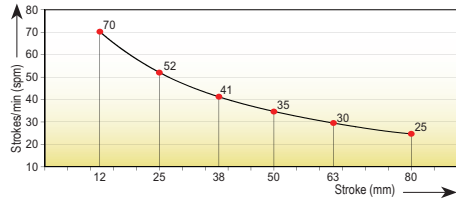

Code	Smax mm	La mm	Lc mm	Fa daN	85% F daN	100% Fc daN	P Bar	V l	Kg
TPH 4300x12.1	12	94	82	4300 ±5% (20°C)	5515	5800	175 (20°C)	0,115	1,82
TPH 4300x25.1	25	120	95		6170	6680		0,174	2,10
TPH 4300x38.1	38	150	112		6375	6965		0,246	2,42
TPH 4300x50.1	50	175	125		6585	7265		0,303	2,61
TPH 4300x63.1	63	210	147		6500	7135		0,392	2,70
TPH 4300x80.1	80	250	170		6560	7225		0,489	3,05

Force/stroke ratio



Initial force/charging pressure ratio

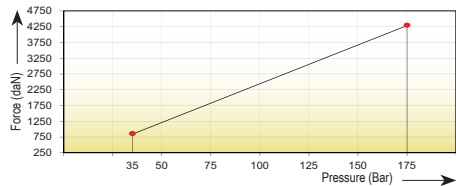

Assembly possibilities



Follow guidelines  
Page 287

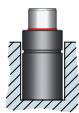

DROP-IN



SCREWS

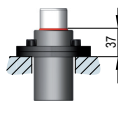

FS 75-FSC 75



FB 75

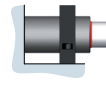

FI 75-FI 75/1